

SITE PLAN

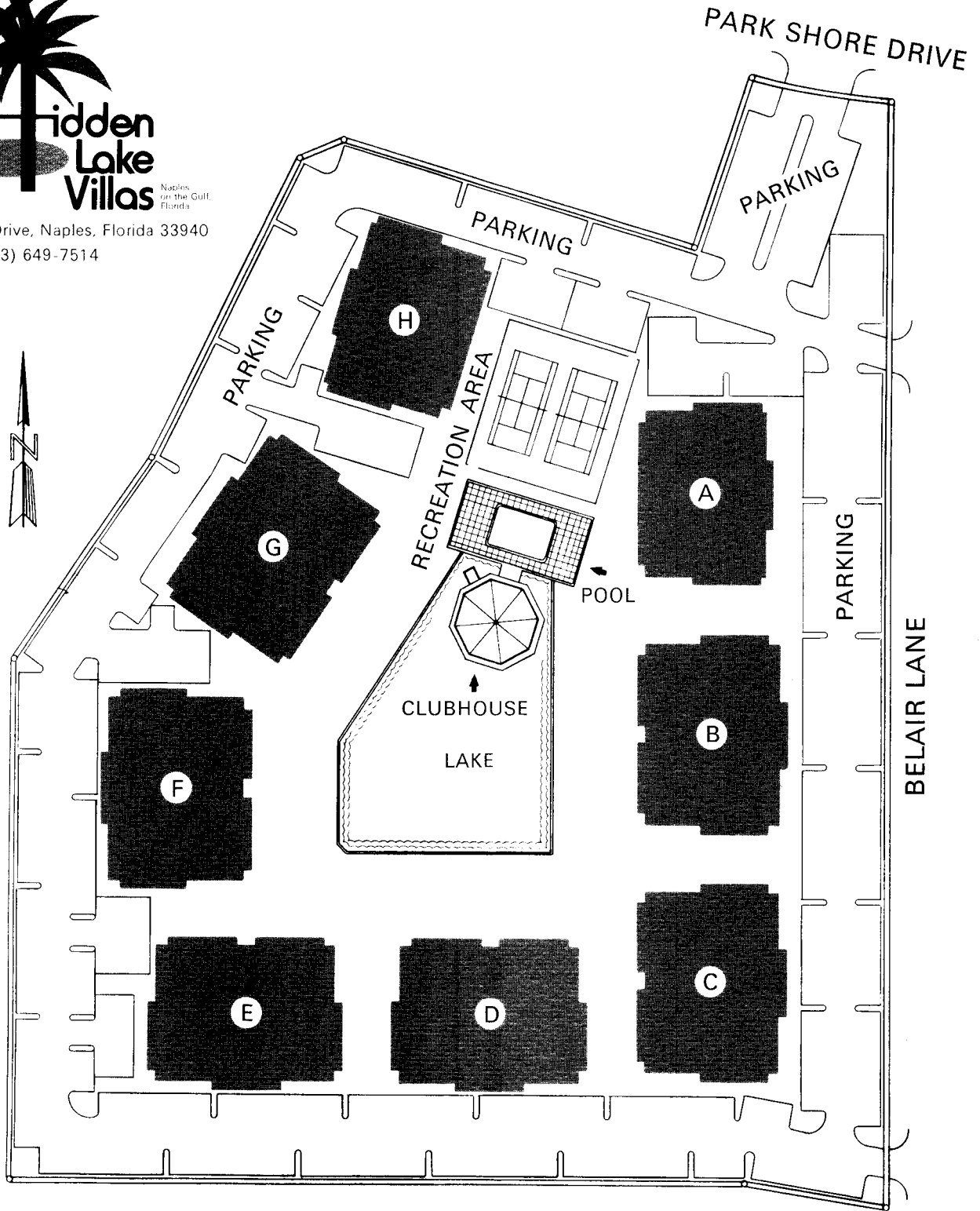

788 Park Shore Drive, Naples, Florida 33940
(813) 649-7514



The recreation area and parking areas will be of the approximate size and in the locations indicated above. Except for one individual parking space which will be assigned as a Limited Common Element to each Unit, all other areas shown above except the Condominium Units will be Common Elements.



**Heftler
Realty Co.**

*Builders of quality
condominiums.*

South Miami, Florida 33143

788 PARK SHORE DRIVE
HIDDEN LAKE VILLAS



PARK SHORE DR.

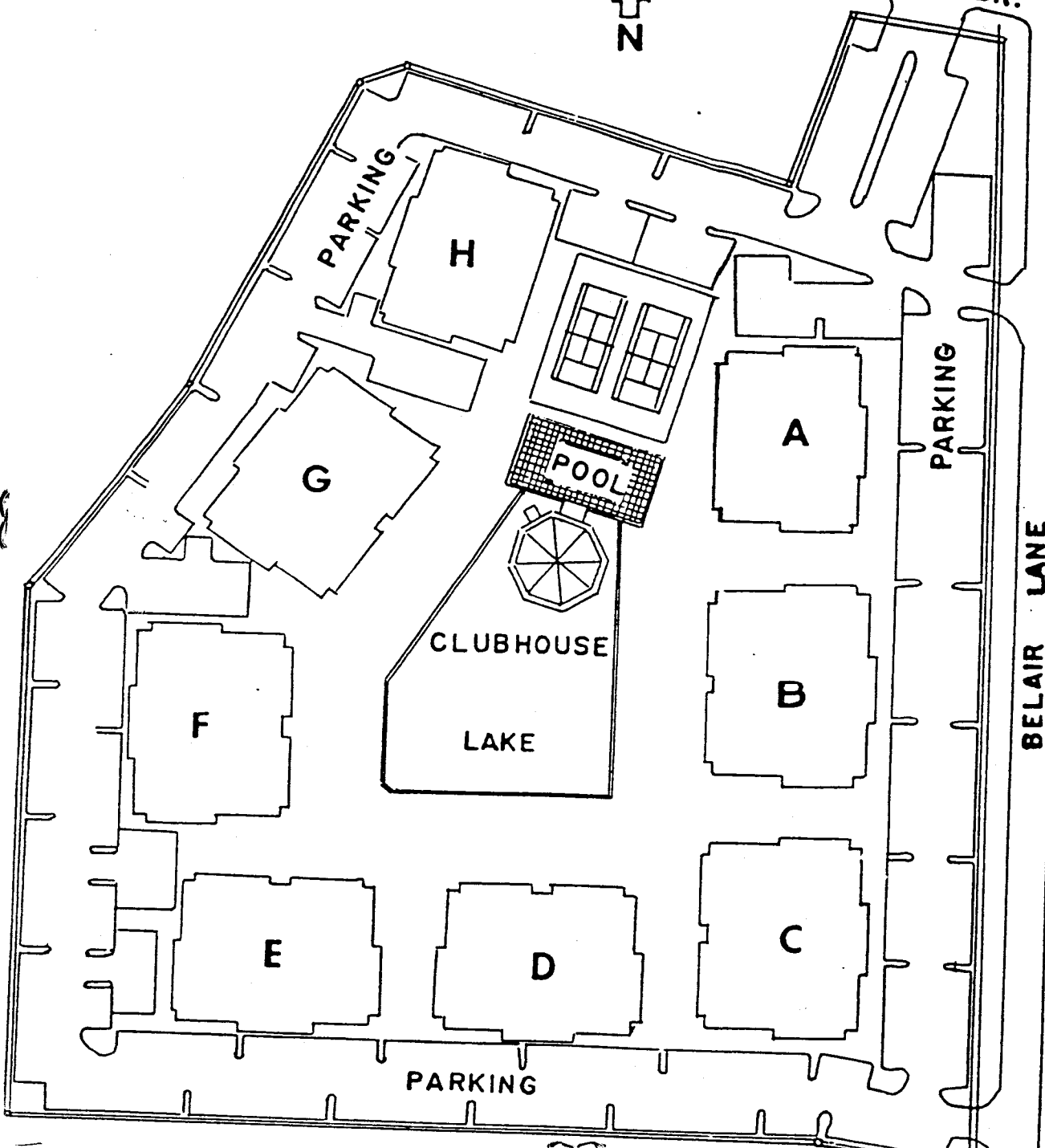

BELAIR LANE